

- Tube Fitting (Double Ferrule)-
 Tube To Male Pipe Thread

45° Male Elbow

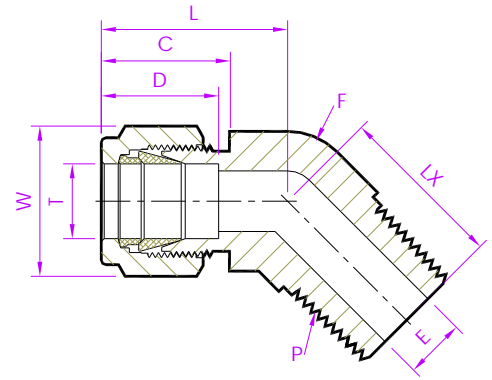
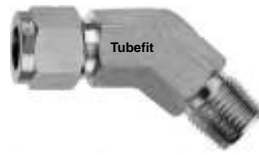

Metric Tube x NPT (M)

TubeFit Part No.	Equivalent Part No. Type 1	Equivalent Part No. Type 2	TUBE OD Ø T	NPT Male Pipe Size P	ØE	D	C	L	LX	Body Hex F	Nut Hex W
			(mm)	(Inch)	Dimensions in Millimetres						
6M - 45MED - 2N	-----	M6MVEL1/8N	6	1/8	4.8	15.3	17.7	16.0	16.8	12.5	14.2
6M - 45MED - 4N	-----	M6MVEL1/4N		1/4						4.8	
8M - 45MED - 2N	-----	M8MVEL1/8N	8	1/8	4.8	16.2	18.6	16.8	16.8	15	16
10M - 45MED - 4N	-----	M10MVEL1/4N	10	1/4	7.1	17.2	19.5	19.0	24.1	20.5	19
12M - 45MED - 6N	-----	M12MVEL3/8N	12	3/8	9.5	22.8	22.0	19.0	24.1	20.5	22.2
12M - 45MED - 8N	-----	M12MVEL1/2N		1/2						9.5	
16M - 45MED - 8N	-----	M16MVEL1/2N	16	1/2	11.9	24.4	22.0	20.6	29.7	27.5	25

NOTE : 1)The E Dimension is the minimum opening & Fittings of this group may be back drilling to lager ID at pipe thread or straight thread end.
 2)Dimension L, C, D is shown in the finger-tight position. 3)Dimensions are for reference only and are subject to change 4)NPT thread as per ANSI B 1.20.1.

- ALL PART NUMBERS ARE PROPRIETARY OF THEIR RESPECTIVE OWNERS. -